

FOR LEASE

Historic Industrial Building

1000 Harding St | Fort Worth, TX 76102



SPACE AVAILABLE

21,000 SF

PRICING INFORMATION

**\$4.50 PSF + NNN
(est. \$2.00)**

LOCATION

**SWC Harding St &
9th St**

- 👁️ 21,000 SF - 4-Story Masonry Construction on 3.6 Acres of Land
- 👁️ Destination Location On The Edge of Downtown w/ Excellent Highway Visibility
- 👁️ 3 (8'x8') Dock Doors, 1 (8'x8') Grade Level Door
- 👁️ Ceiling Height: 10' - 50'
- 👁️ Convenient Access to I-35W, Spur 280 & MLK Jr Fwy
- 👁️ Zoning: "H" - Central Business

DEMOGRAPHICS*	1 MILE	2 MILE	3 MILE	5 MILE
Population	8,371	29,775	81,909	274,059
Employees	42,069	86,254	124,632	182,951
Average HH Income	\$74,588	\$59,432	\$61,177	\$61,306
2017-2022 Annual Rate	3.01%	3.35%	2.87%	2.55%
Traffic Count	31,000 VPD @ State Spur 280 MLK Jr Fwy			

*STDBonline.com 2018

1000 Harding St

Industrial Special Use Facilities
Conveniently Located in CBD!

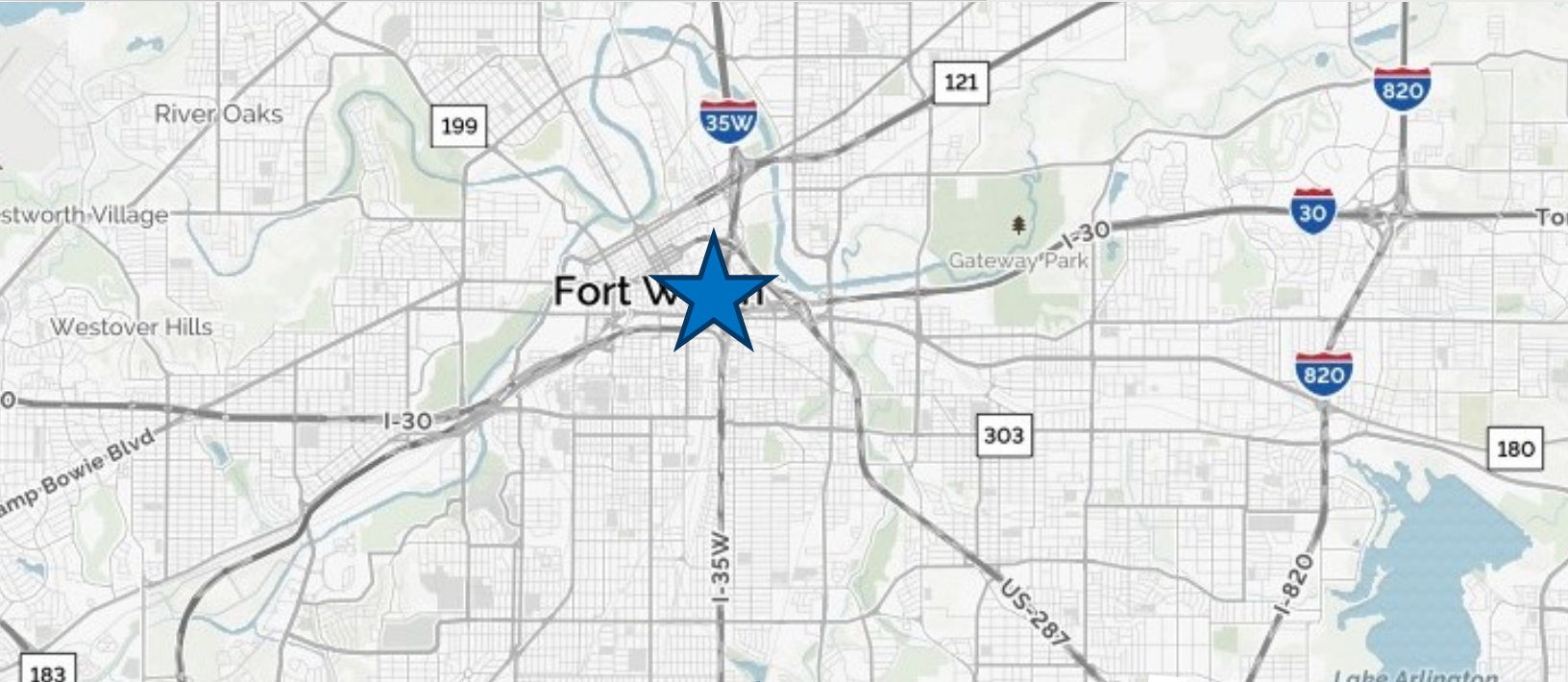

1000 Harding St

Industrial Special Use Facility
Conveniently Located in CBD!



1000 Harding St

Industrial Special Use Facility
Conveniently Located in CBD!

North Building Floor Plans

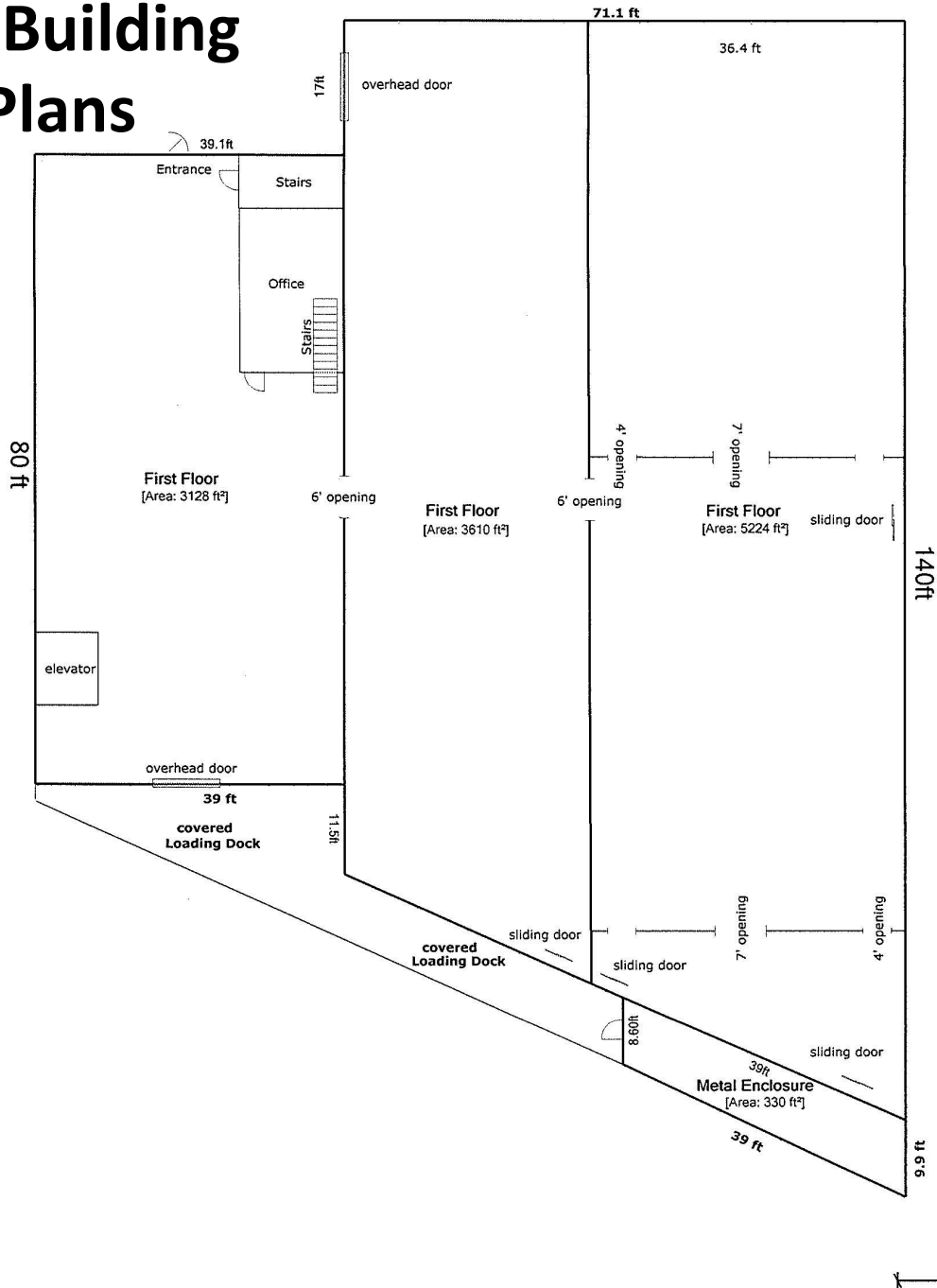

Living Area	Area Calculation		
First Floor	3128 ft ²	First Floor	x 1.00 = 3128 ft ²
First Floor	3610.15 ft ²	80ft x 39.1ft x 1.00 =	3128 ft ²
First Floor	5224.06 ft ²	First Floor	x 1.00 = 3610.15 ft ²
Metal Enclosure	329.84 ft ²	Δ 34.40ft x 122.44ft x 0.46 =	1922.98 ft ²
		Δ 31.1ft x 108.5ft x 0.50 =	1687.18 ft ²
		First Floor	x 1.00 = 5224.06 ft ²
		Δ 40ft x 122.44ft x 0.50 =	2448.71 ft ²
		Δ 43.36ft x 140ft x 0.46 =	2775.35 ft ²
		Metal Enclosure	x 1.00 = 329.84 ft ²
		Δ 39.54ft x 9.90ft x 0.45 =	176.51 ft ²
Total Living Area (rounded):	12292 ft²	Δ 39ft x 8.60ft x 0.46 =	153.33 ft ²

1000 Harding St

Industrial Special Use Facility
Conveniently Located in CBD!

North Building Floor Plans

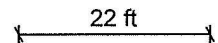
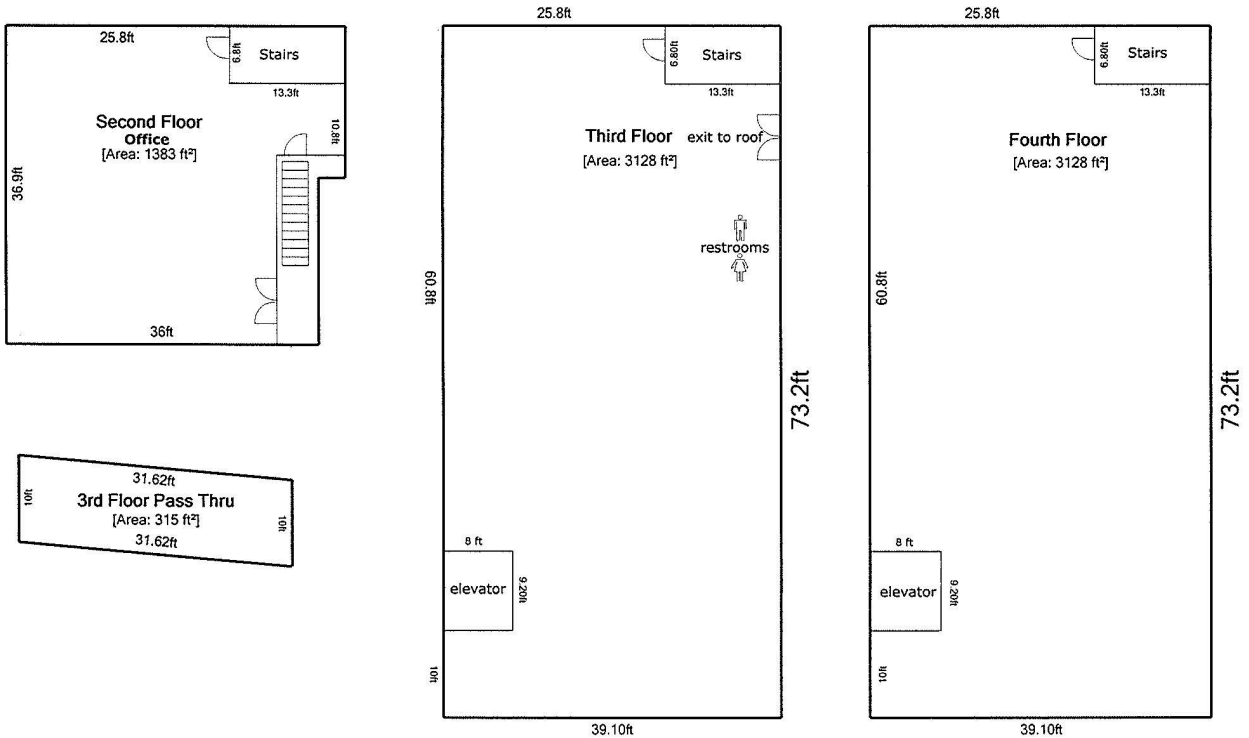

Living Area	Area Calculation				
Second Floor	1382.96 ft ²	Second Floor			x 1.00 = 1382.96 ft²
Third Floor	3128.00 ft ²	□	3.10ft x	17.6ft x	1.00 = 54.56 ft ²
Fourth Floor	3128 ft ²	□	36ft x	36.9ft x	1.00 = 1328.4 ft ²
3rd Floor Pass Thru	315 ft ²	Third Floor			x 1.00 = 3128.00 ft²
		□	80ft x	39.10ft x	1.00 = 3128.00 ft ²
		Fourth Floor			x 1.00 = 3128 ft²
		□	19.2ft x	39.10ft x	1.00 = 750.72 ft ²
		Δ	39.1ft x	60.8ft x	0.50 = 1188.64 ft ²
		Δ	39.10ft x	60.8ft x	0.50 = 1188.64 ft ²
		3rd Floor Pass Thru			x 1.00 = 315 ft²
		Δ	31.62ft x	2.80ft x	0.50 = 44.10 ft ²
		Δ	31.62ft x	2.80ft x	0.50 = 44.10 ft ²
Total Living Area (rounded):	7954 ft²	□	7.20ft x	31.5ft x	1.00 = 226.8 ft ²

1000 Harding St

Industrial Special Use Facility
Conveniently Located in CBD!

South Building Floor Plans

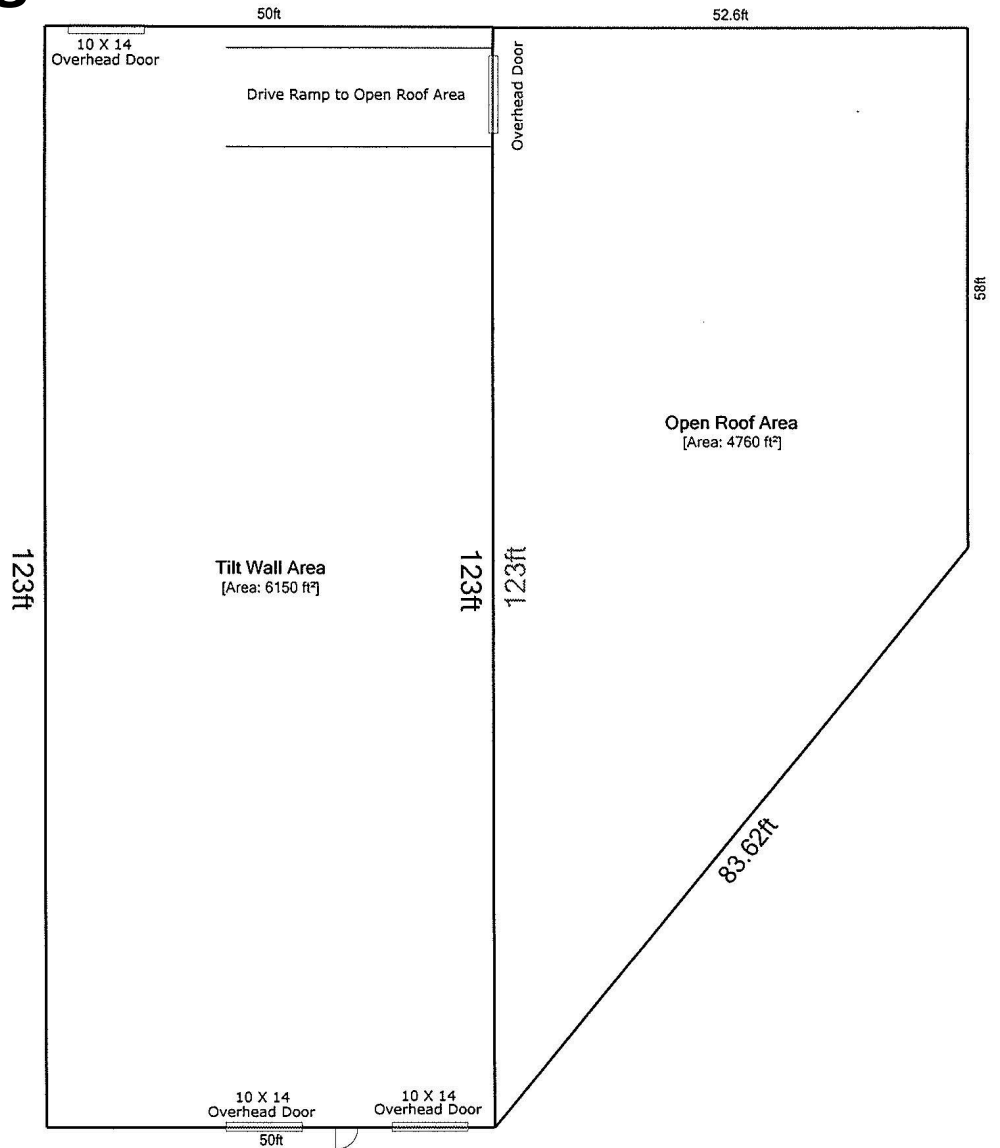

22 ft

Living Area	Area Calculation			
Tilt Wall Area	6150 ft ²	Tilt Wall Area		x 1.00 = 6150 ft ²
Open Roof Area	4760.3 ft ²	123ft x 50ft x 1.00 =	6150 ft ²	
		Open Roof Area		x 1.00 = 4760.3 ft ²
		Δ 65ft x 83.62ft x 0.31 =	1709.5 ft ²	
Total Living Area (rounded):	10910 ft²	58ft x 52.6ft x 1.00 =	3050.8 ft ²	

1000 Harding St

Industrial Special Use Facility
Conveniently Located in CBD!

